



# Prestbury Road, Prestbury, Cheltenham, GL52

£150,000

🛏️ 1 🚿 1 🚗 1



- One Double Bedroom Apartment
- First Floor Period Apartment
- Open Plan Living Room/ Kitchen
- Gas Central Heating
- Modern Kitchen
- Modern Bathroom
- First Come First Served Parking
- Close to Town Centre



A well-presented one double bedroom apartment, ideally located within walking distance to the town centre.



381 sq.ft. (35.4 sq.m.) approx.

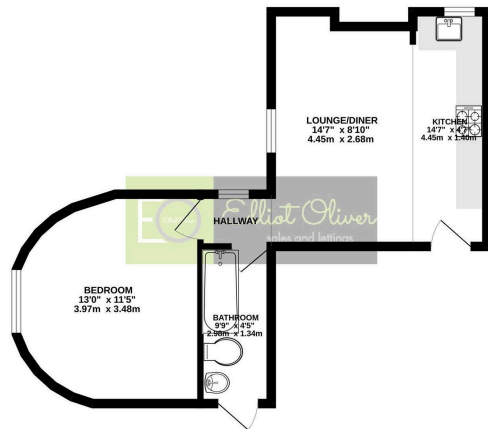

TOTAL FLOOR AREA: 381 sq.ft. (35.4 sq.m.) approx.  
 \*All room areas are approximate and are based on the information provided by the seller. The actual area may vary slightly from the stated area. The actual area will be determined by a professional surveyor. The actual area will be determined by a professional surveyor. The actual area will be determined by a professional surveyor.

Energy Efficiency Rating		
	Current	Potential
Very energy efficient - lower running costs		
(92 plus) <b>A</b>		
(81-91) <b>B</b>		
(69-80) <b>C</b>		75
(55-68) <b>D</b>	64	
(39-54) <b>E</b>		
(21-38) <b>F</b>		
(1-20) <b>G</b>		
Not energy efficient - higher running costs		
<b>England &amp; Wales</b>	EU Directive 2002/91/EC	



Elliot Oliver Sales  
 101 Promenade, Cheltenham GL50 1NW  
 01242 321091  
 www.elliottoliver.co.uk

